



Pos-I-Tie® ThermalClip® Brick Veneer Anchoring System

ThermalClip® creates a break in the thermal transfer between the veneer wire tie and the barrel.

ThermalClip® allows for use of dissimilar metals between the veneer anchor and barrel screw.

The Pos-I-Tie® ThermalClip® system fully complies with all code requirements.

Offers efficient labor and cost-saving installation.

Safe to install. No “spinning wings” that can potentially cause damage to fingers.

Wood Stud Backup Wall Application

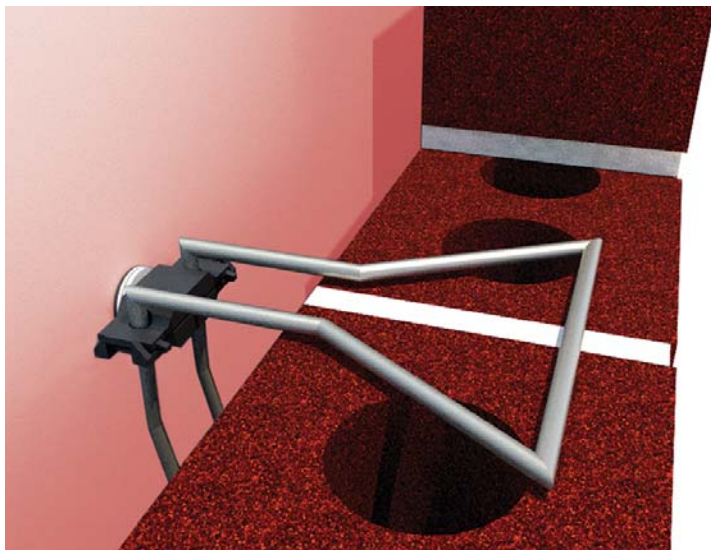
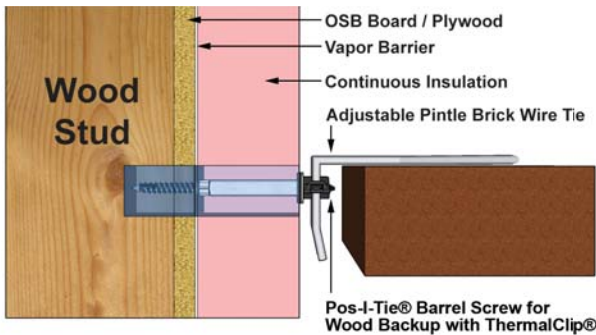

Pos-I-Tie® ThermalClip® Installation

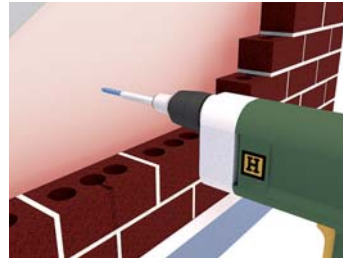

Install the Original Pos-I-Tie® into the backup wall using a chuck adapter and power drill.

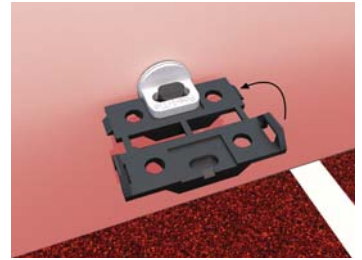

Insert the ThermalClip® as shown and fold over the head of the Original Pos-I-Tie® Anchor.

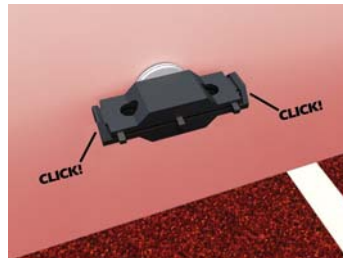

The ThermalClip® is secured when both sides are snapped into place.



Insert the pintle wire tie or stone anchor into the two holes of the ThermalClip®.

Innovative Design

- The ThermalClip® is manufactured from a high strength composite resin that acts as a thermal break between the wire tie and the Barrel Screw.
- The ThermalClip® also creates a dissimilar metals break allowing the use of Stainless Steel Ties or Stone Anchors with the Original Pos-I-Tie®.

Composite Resin Material

- Dramatically decreases thermal transfer. The proprietary composite resin has very low thermal conductivity; over 100 times less than metals such as steel.
- Flame resistant with a UL 94 V-0 rating
- Meets “freeze-thaw” conditions
- No reaction with alkalines in mortar

The CavityComplete® Wood Stud Wall System excludes the masonry veneer, wood studs, interior gypsum board and exterior sheathing. A detailed list of the components is available at www.CavityComplete.com.