



THERMAL INSULATING WOOL (TIW) INSULATION TYPE I-HP BLANKETS AND TYPE II-HP BOARDS

INSTALLATION INSTRUCTIONS & GUIDELINES

TECHNICAL INFORMATION

TIW Type I-HP and Type II-HP are usually impaled over welded pins on flat surfaces. For irregular surfaces, they are cut in segments and impaled over welded pins to hold in place.

INSTALLATION

Product should be kept dry during shipping, storage, and installation.

TIW Type I-HP and Type II-HP can be easily cut with a knife and fit neatly into irregularly shaped areas.

TIW Types I-HP and II-HP insulations can be installed directly on heated flat and curved surfaces by attaching with welded pins or studs, finishing with sheet metal or metal mesh and insulating cement, then canvassed and painted.

Pins with speed washers or studs and nuts should be installed on 16-inch (400 mm) (maximum) spacing and not more than 4 inches (100 mm) from the edge of the insulation.

The insulation is normally impaled over the pins or studs and the enclosing sheet metal or metal mesh secured to the same fasteners. Joints of the sheet metal finish are offset from joints of the insulation.

TIW Types I-HP and II-HP insulations may be installed in either single or multiple layers at all temperatures up to 1,000°F (538°C).

For temperatures over 400°F (204°C), good insulation practice suggests double-layer application, staggering the insulation joints, i.e., overlapping the first-layer joints with the second layer, regardless of insulation type, for improved thermal performance.

When installing a single-layer installation of any type, attention needs to be paid to the alignment of the insulation joints, requiring good workmanship to minimize heat loss and hot spots at the insulation joints.

Maximum allowable thicknesses at 1,000°F (538°C):

- TIW Type I-HP, 8-½" (216 mm)
- TIW Type II-HP, 6" (152 mm)

EXAMPLES OF INSTALL

PANEL CONSTRUCTION

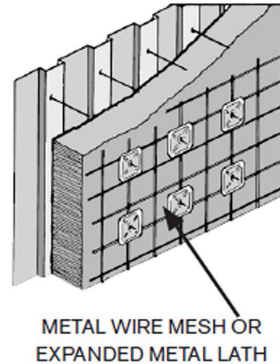

FLUSH APPLICATION — METAL LAGGING

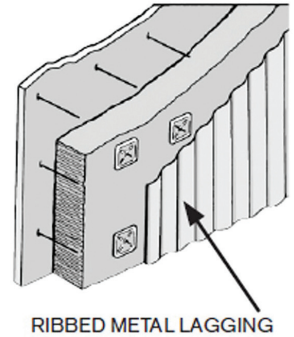

FLUSH APPLICATION — CANVASSED, PAINTED

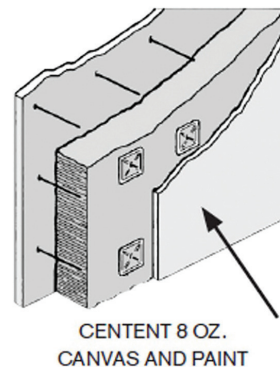

OWENS CORNING INSULATING SYSTEMS, LLC
ONE OWENS CORNING PARKWAY
TOLEDO, OH 43659 USA
1-800-GET-PINK®
www.owenscorning.com